

# Victor®

## EASY TO USE INSTRUCTIONS

## THE ULTIMATE STINK BUG T R A P

### Choose a Location... Household Use Only

Pick a location that is close to the area where the stink bugs are entering your house. (Windows, Doors, Dryer vents, etc.)

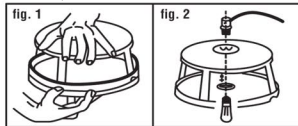

**Step 1:** Separate the top canopy of the trap from the bottom tray using thumb grips as shown (fig. 1)

**Step 2:** Carefully place the light socket into the hole in the top of the trap canopy. (fig. 2)

**Step 3:** Secure the socket in place with the threaded bulb protector provided. Do not over tighten.

**Step 4:** Gently insert the bulb provided.

### Insert the Glue Disc...

Grasp tab and remove release paper from glue disc. (fig. 3).

Place the glue disc in the bottom of the trap. (fig 4)

Note: Glue can be cleaned from skin or surface using vegetable oil.

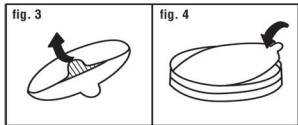

### Insert Stink Bug Lure...

Open lure package and place lure in the middle of the glue disc. Wash hands after placing lure to remove lure scent from your hands.

### Reassemble Trap...

To reassemble the trap, align the top canopy directly over the bottom tray and press down firmly.

Manufactured by:

Woodstream Corporation  
69 North Locust Street  
Lititz, PA 17543

### For Best Results...

- Make sure that you have removed the release paper from refill disc
- Change the refill disc every 2-4 weeks, regardless of the amount of stink bugs trapped. A fresh disc is more effective than a used one.

Refills and replacement lures are available at [www.saferbrand.com](http://www.saferbrand.com)

### PRECAUTIONARY NOTES

- KEEP OUT OF REACH OF CHILDREN
- Always unplug the trap before replacing refills or light bulbs
- Replace light bulb with a standard "night light" 7 watt bulb, 110V.
- Protect your pets against electrical shock. DO NOT let your pets chew or bite the electrical cord.

### Warranty

The Ultimate Stink Bug Trap is warranted to be free from defects in the material and workmanship under normal use for a period of 1 year from the date of purchase except for light bulb and glue disc. Contact customer service at 1800-800-181

### IMPORTANT SAFETY INSTRUCTIONS WARNING

When using electric appliances, basic precautions should always be followed, including the following:

- a) Read all the instructions before using the appliance.
- b) To reduce the risk of injury, close supervision is necessary when the product is used near children.
- c) Do not contact moving parts.
- d) Do not use outdoors.
- e) Do not unplug by pulling on cord. To unplug, grab the plug, not the cord.
- f) Unplug from outlet when not in use and before service or cleaning
- g) Do not operate any product with a damaged cord or plug, after the product malfunctions or is dropped or damaged in any manner. Return product to the nearest authorized service facility for examination, repair, or electrical or mechanical adjustment.
- h) To reduce the risk of electrical shock, do not put product in water or other liquid. Do not place or store product where it can fall or be pulled into a tub or sink.
- i) Save all safety and operating instructions for future reference.
- j) To reduce the risk of electric shock, this appliance has a polarized plug (one blade is wider than the other) This plug will fit in a polarized outlet only one way. If the plug does not fit fully in the outlet, reverse the plug. If it still doesn't fit, contact a qualified electrician to install a proper outlet. Do not change the plug in any way.

## SAVE THESE INSTRUCTIONS